

# I Love Mountains Day 2010

LOBBYING — before and after the rally you may come to the Annex to see your legislator. If not available, please leave them a written message or Valentines card asking for their support of the Stream Saver Bill and clean energy legislation.

**Parking.** This is the top level of a six-level parking garage). Between 10:30 and 11:15 a.m. a KFTC van will make regular stops near the elevator in this parking lot (level 1 or ground level) to transport people to the the March.

CAFETERIA:  
In the basement of the Annex.

Ramp  
to lower  
garage levels

A TUNNEL goes from the  
Capitol to the Annex.

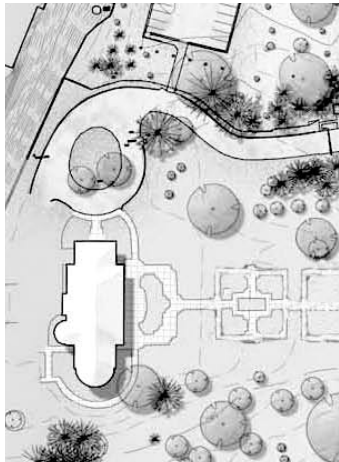

- ✓ Senators have offices on the second floor of the Capitol Annex. House members have offices on the third and fourth floor of the Capitol Annex.
- ✓ When lobbying, go to the Receptionist's desk on the proper floor to ask to see the legislator. If you already have an appointment, let them know this. You can also leave notes and Valentines with the receptionist for your legislators if they are unable to see you.
- ✓ Use the stairs or elevators near the front entrance of the Annex to move up and down floors.
- ✓ The governor's office is on the first floor of the Capitol (just off from the rotunda).

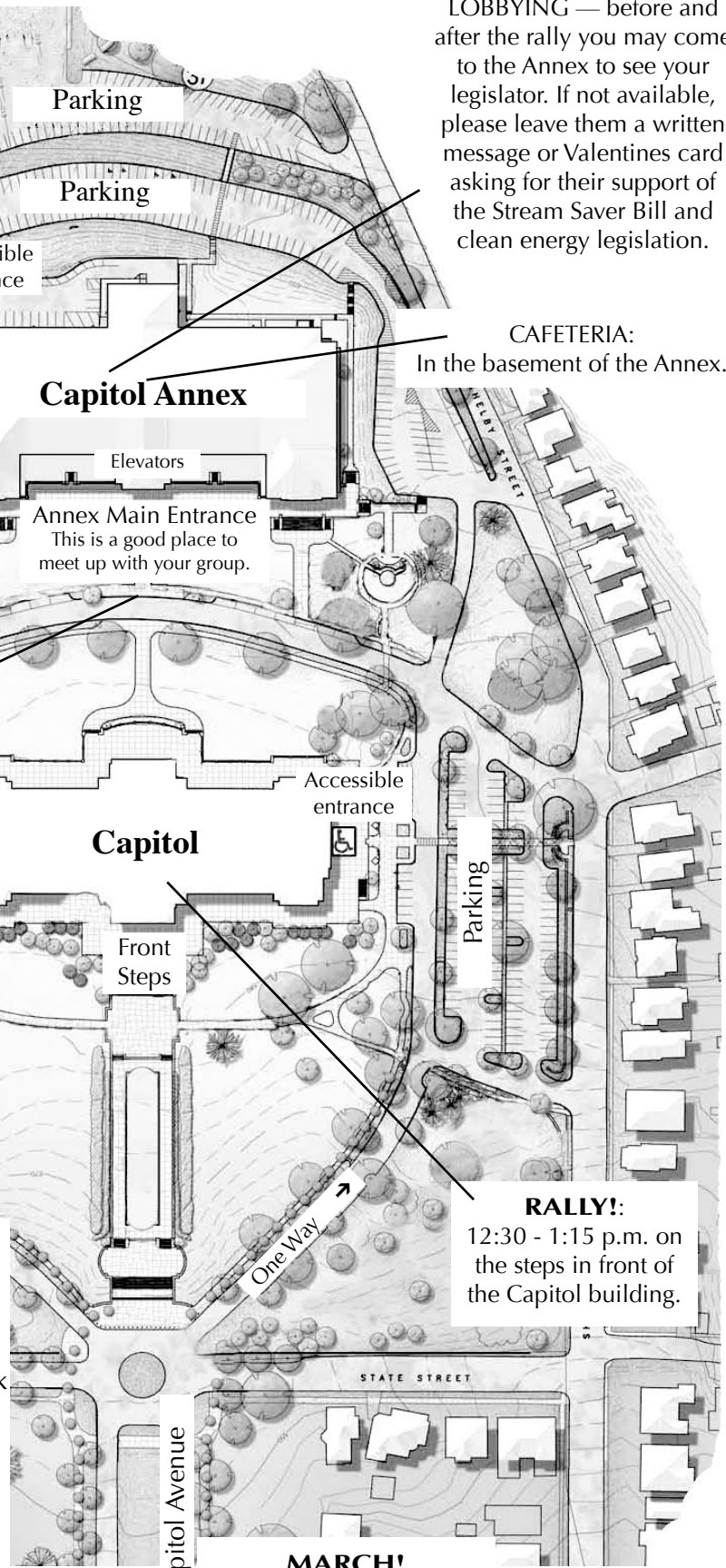

**RALLY!:**  
12:30 - 1:15 p.m. on  
the steps in front of  
the Capitol building.

Capitol Avenue  
↓

**MARCH!**  
11 a.m. Gather at Kentucky  
River bridge straight out  
Capitol Avenue (.6 mile); at  
11:30 we will march to the  
Capitol for rally.